

SPECIFICATIONS

(RoHS Compliant)



Customer: CommScope 860502319
Model Number: MFXE24Z6D3-E2
Part Number: 19044017A

Rev: C03
Rev: 03
July 27,2020

Mechanical Drawing:

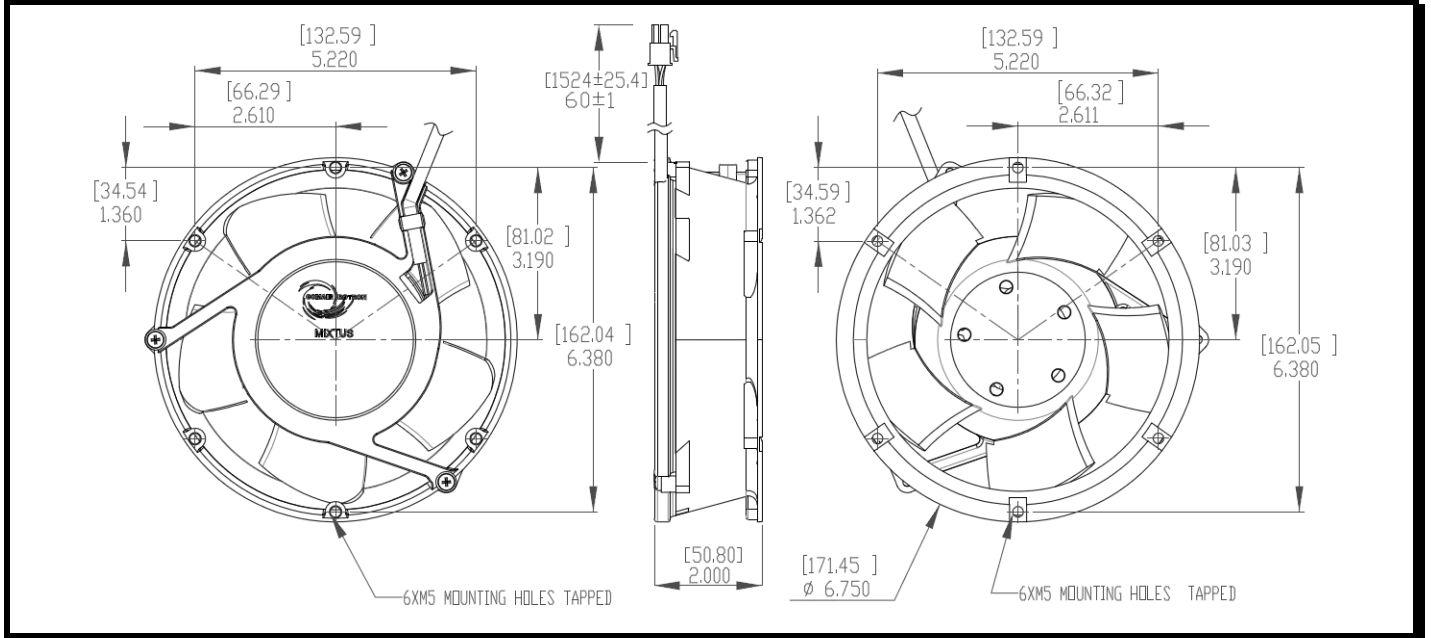

Motor:

Nominal Voltage = 24 vdc
Operating Voltage Range = 16 - 32vdc
Nominal Running Current = 3.1 amps
Max. Locked Rotor Current = 3.9 amps
Running Power = 74.4 watts
Average Speed = 5400 rpm
Bearings = Ball
Air Flow = 394 CFM
Acoustic = 72 dBA

Construction:

Venturi: Die Cast Aluminum Alloy, Black.
Propeller: Plastic, Black, UL 94V-0.

Agency Approvals:

UL, CUL, CE

Life Expectancy:

This fan is designed for continuous duty life of 72,000 hours at 40°C.

Speed Control(J-CURVE,10KΩ NTC):

TEMPERATURE (°C) VS. RPM	
TEMPERATURE (°C)	RPM (±10%)
-40°C TO 10°C	0
10°C TO 25°C	1500
25°C TO 35°C	2800
40°C	4000
ABOVE 45°C	5400

Additional Features:

Brushless DC Motor
Locked Rotor Protection
Reverse Polarity Protected
Automatic Restart Capability
Operating Temperature: -40°C to 70°C
Storage Temperature: -40°C to 85°C
Enviroshield: Type2(IP55)

Alarm Output (FPS):

Open Collector (NPN Transistor)
High on Pass, Low on Fail
Vcc: 32Vdc Max
Sink Current (Ic): 20mA Max
Isolated: No
Latching: No
Delay: 10±4s

Termination:

60±1" length Harness Assembly,
Connector – Molex 39-01-2065
Contacts – Molex 39-00-0077

Pin 1: Black – Return(-) 20AWG, UL 1007
Pin 2: Blue – FPS 20AWG, UL 1007
Pin 3: Red – Power(+) 20AWG, UL 1007
Pin 4: Not used
Pin 5: White – Thermistor 22AWG, UL 1007
Pin 6: Yellow – Thermistor 22AWG, UL 1007

PQ Curve:

